



MARIN MUNICIPAL WATER DISTRICT

220 Nellen Avenue Corte Madera CA 94925-1169
www.marinwater.org

February 28, 2014

Maureen Cassingham
Executive Officer
Marin Emergency Radio Authority
95 Rowland Way
Novato CA 94945

Re: Forbes Hill Reservoir Site – San Rafael CA
District Lease No. 67

Dear Ms. Cassingham:

Carl Gowan, P.E., Senior Engineer has advised you of our plans to replace the liner and install a multi-span aluminum roof cover for our reservoir. The installation of the new roof cover necessitates that the PG&E power lines and ATT communication lines for your facility be relocated underground.

Section 18, paragraph one of the lease agreement between the Marin Municipal Water District (MMWD) and the Marin Emergency Radio Authority (MERA) explains that if MERA's occupancy conflicts with our operations, our operations shall take priority and precedence over MERA's operations. Paragraph three of that section states that upon receiving notice from MMWD of such interference, MERA shall take steps necessary to eliminate the interference. Now that we have plans to upgrade our facility, we require that MERA's utility lines be relocated underground and that MERA bear the cost of the relocation.

In order to relocate the utility lines in an area that will not interfere with our operations, we have prepared and enclosed a legal description and plat map describing the location for your underground utility lines.

Any further questions should be directed to Carl Gowan at (415) 945-1577 or by e-mail at cgowan@marinwater.org.

Sincerely,

Krishna Kumar
General Manager
Marin Municipal Water District

Enclosure: Legal description and plat map

KK:SG:mp

cc: Carl Gowan, P.E., Senior Engineer, MMWD
Stanley Graham, Real Property Agent, MMWD

EXHIBIT A

An easement for underground utility purposes over a portion of the lands of the Marin Municipal Water District, said lands lying situate in the City of San Rafael, County of Marin, State of California, said lands of the Marin Municipal Water District being described as the First Parcel under the Third Section in the Final Order of Condemnation, "Marin Municipal Water District, a public corporation, vs. Marin Water and Power Company, a corporation, and Mercantile Trust Company of San Francisco, a corporation", Superior Court Case No. 4495, recorded in Book 215 of Deeds, at page 337, Marin County Records, said underground utility easement being a 5 foot easement, lying 2.50 feet on each side of the following described centerline;

Commencing at the northeasterly corner of the parcel referenced above;

Thence, along the northeasterly line of said parcel, North 72° 36' 00" West, a distance of 280.59 feet;

Thence, leaving said northeasterly line, South 17° 24' 00" West, a distance of 99.70 feet;

Thence, South 45° 51' 13" West, a distance of 37.27 feet to the **True Point of Beginning**;

Thence, South 14° 56' 19" East, a distance of 55.91 feet;

Thence, South 16° 17' 22" West, a distance of 110.71 feet to terminate at the southwesterly line of the parcel referenced above.

The sidelines of said 5 foot easement at the northerly terminus are to terminate at the line recited above as South 45° 51' 13" West, and its southwesterly prolongation.

The sidelines of said 5 foot easement at the southerly terminus are to terminate at the southwesterly line of the parcel referenced above.

End of Legal Description

Prepared by:

Lionel Keith Vincent, PLS 8248

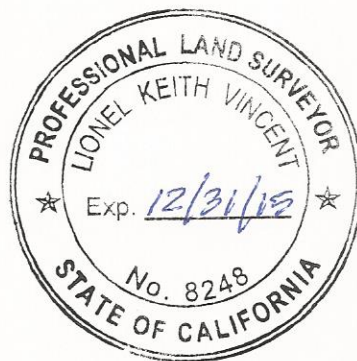

EXHIBIT B



GROVE HILL OWNERS ASSN.
D.N. 1986-050328

MARIN EMERGENCY
RADIO AUTHORITY
MMWD LEASE NO. 67

POINT OF COMMENCEMENT

POINT OF BEGINNING
5' UTILITY EASEMENT

LANDS OF MMWD
215 DEEDS 337

"FORBES HILL RESERVOIR"

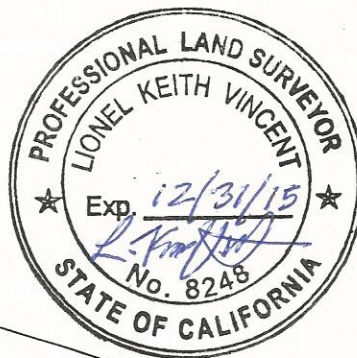

MAP OF WESTLAND TERRACE
SUB. 2
6 R.M. 16

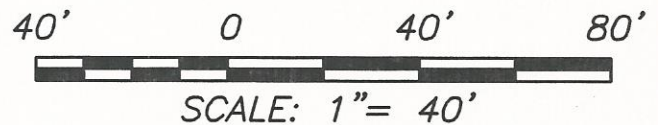

SANTA MARGARITA DR.
S 72° 36' 00" E 600.00'

S 16° 17' 22" W 110.71'

S 14° 56' 19" E 55.91'

5.00'

S 45° 51' 13" W 37.27'

S 17° 24' 00" W 99.70'

N 72° 36' 00" W 280.59'

N 72° 36' 00" W 600.00'

MARIN MUNICIPAL WATER DISTRICT
220 NELLEN AVE., CORTE MADERA, CA 94925 (415) 924-4800

MARIN EMERGENCY RADIO AUTHORITY
5 FOOT UTILITY EASEMENT

DATE: FEB 2014 SHEET: 1 OF 1

PREPARED BY: KV DESIGN BY: CG

APPURTENANT TO MMWD LEASE NO.67
SAN RAFAEL, FORBES HILL RESERVOIR